

TRIVAC D 4 B and D 8 B



TRIVAC D 4 B (left) and TRIVAC D 8 B (right)

USA pumps max. length
 D 4 B: 485 mm (19.1")
 D 8 B: 555 mm (21.9")

Type	DN	a	b	b ₁	b ₂	c	e	e ₁	h	h ₁	h ₂	h ₃	h ₄	l	l ₁	m	n	o	
D 4 B (Part No. 113 09)	16 KF	mm in.	75 2.95	162 6.38	147 5.79	132 5.23	100 3.94	- 6.69	170 6.69	265 10.43	215 8.46	200 7.87	230 9.06	259 10.20	- 17.91	455 17.91	198 7.80	99 3.90	108 4.25
D 4 B (Part No. 112 45)	16 KF	mm in.	75 2.95	162 6.38	147 5.79	132 5.23	100 3.94	102 4.02	- 10.43	265 10.43	215 8.46	200 7.87	230 9.06	234 9.21	437 17.21	- -	198 7.80	99 3.90	108 4.25
D 4 B (Part No. 112 46)	16 KF	mm in.	75 2.95	162 6.38	147 5.79	132 5.23	100 3.94	89 3.5	- 10.43	265 10.43	215 8.46	200 7.87	230 9.06	223 8.78	438 17.24	- -	198 7.80	99 3.90	108 4.25
D 4 B (Part No. 140 140)	16 KF	u. r.	u. r.	u. r.	u. r.	u. r.	u. r.	u. r.	u. r.	u. r.	u. r.	u. r.	u. r.	u. r.	u. r.	u. r.	u. r.	u. r.	u. r.
D 4 B (Part No. 140 081)	16 KF	mm in.	75 2.95	162 6.38	147 5.79	132 5.23	100 3.94	185 7.28	- 10.43	265 10.43	215 8.46	200 7.87	230 9.06	264 10.39	455 17.91	- -	198 7.80	99 3.90	108 4.25
D 8 B (Part No. 113 21)	16 KF	mm in.	100 3.94	162 6.38	147 5.79	132 5.23	100 3.94	- 6.69	170 6.69	265 10.43	215 8.46	200 7.87	230 9.06	259 10.20	- 18.90	480 18.90	198 7.80	99 3.90	108 4.25
D 8 B (Part No. 112 55)	16 KF	mm in.	100 3.94	162 6.38	147 5.79	132 5.23	100 3.94	102 4.02	- 10.43	265 10.43	215 8.46	200 7.87	230 9.06	234 9.21	462 18.19	- -	198 7.80	99 3.90	108 4.25
D 8 B (Part No. 112 56)	16 KF	mm in.	100 3.94	162 6.38	147 5.79	132 5.23	100 3.94	89 3.5	- 10.43	265 10.43	215 8.46	200 7.87	230 9.06	223 8.78	463 18.23	- -	198 7.80	99 3.90	108 4.25
D 8 B (Part No. 140 150)	16 KF	u. r.	u. r.	u. r.	u. r.	u. r.	u. r.	u. r.	u. r.	u. r.	u. r.	u. r.	u. r.	u. r.	u. r.	u. r.	u. r.	u. r.	u. r.
D 8 B (Part No. 140 082)	16 KF	mm in.	100 3.94	162 6.38	147 5.79	132 5.23	100 3.94	185 7.28	- 10.43	265 10.43	215 8.46	200 7.87	230 9.06	264 10.39	480 18.90	- -	198 7.80	99 3.90	108 4.25

u. r. = upon request

Dimensional drawing for the TRIVAC D 4 B and D 8 B

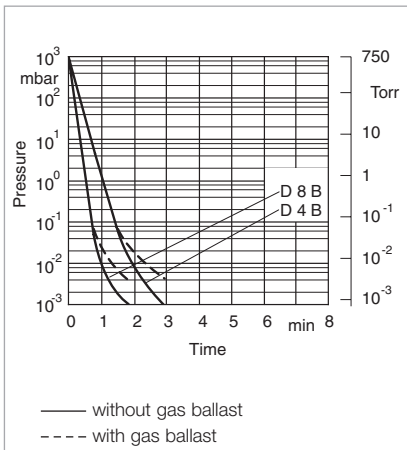

Pump-down characteristics of a 10 l vessel at 50 Hz

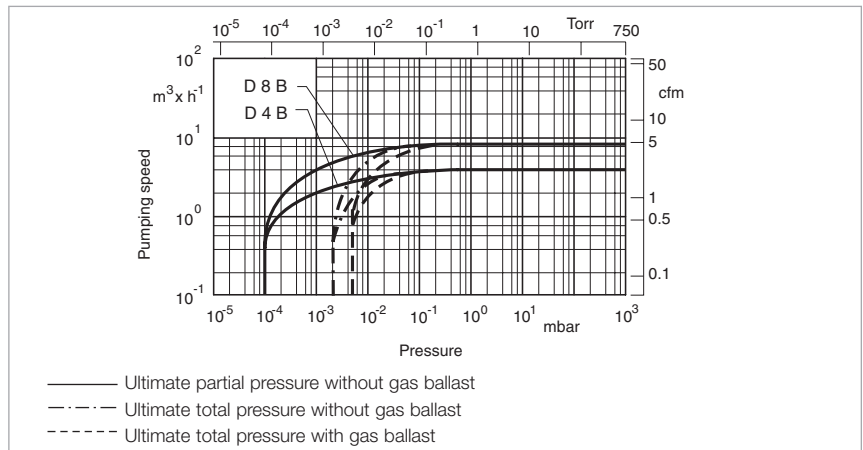

Pumping speed characteristics at 50 Hz (60 Hz curves at the end of the section)

Technical Data

TRIVAC D 4 B two-stage

TRIVAC D 8 B two-stage

		50 Hz	60 Hz	50 Hz	60 Hz
Nominal pumping speed ¹⁾	m ³ x h ⁻¹ (cfm)	4.8 (2.8)	5.8 (3.4)	9.7 (5.7)	11.6 (6.9)
Pumping speed ¹⁾	m ³ x h ⁻¹ (cfm)	4.2 (2.5)	5 (3)	8.5 (5)	10.2 (6)
Ultimate partial pressure without gas ballast ¹⁾	mbar (Torr)	10 ⁻⁴ (0.75 x 10 ⁻⁴)	10 ⁻⁴ (0.75 x 10 ⁻⁴)	10 ⁻⁴ (0.75 x 10 ⁻⁴)	10 ⁻⁴ (0.75 x 10 ⁻⁴)
Ultimate total pressure without gas ballast ¹⁾	mbar (Torr)	< 2 x 10 ⁻³ (< 1.5 x 10 ⁻³)	< 2 x 10 ⁻³ (< 1.5 x 10 ⁻³)	< 2 x 10 ⁻³ (< 1.5 x 10 ⁻³)	< 2 x 10 ⁻³ (< 1.5 x 10 ⁻³)
Ultimate total pressure with gas ballast ¹⁾	mbar (Torr)	< 5 x 10 ⁻³ (< 3.8 x 10 ⁻³)	< 5 x 10 ⁻³ (< 3.8 x 10 ⁻³)	< 5 x 10 ⁻³ (< 3.8 x 10 ⁻³)	< 5 x 10 ⁻³ (< 3.8 x 10 ⁻³)
Water vapor tolerance ¹⁾	mbar (Torr)	30 (22.5)	30 (22.5)	25 (18.8)	25 (18.8)
Water vapor capacity	g/h	93	93	157	157
Oil filling, min. / max.	l (qt)	0.3 / 0.8 (0.3 / 0.85)	0.3 / 0.8 (0.3 / 0.85)	0.3 / 0.9 (0.3 / 0.95)	0.3 / 0.9 (0.3 / 0.95)
Noise level ²⁾ to DIN 45 635, without / with gas ballast	dB(A)	50 / 52	50 / 52	50 / 52	50 / 52
Admissible ambient temperature	°C (°F)	12 - 40 (54 - 104)	12 - 40 (54 - 104)	12 - 40 (54 - 104)	12 - 40 (54 - 104)
Motor rating ²⁾	W (HP)	370 (0.50)	370 (0.50)	370 (0.50)	370 (0.50)
Nominal speed	rpm	1500	1800	1500	1800
Type of protection ³⁾	IP	54	54	54	54
Weight ²⁾	kg (lbs)	18.7 (41.2)	18.7 (41.2)	21.2 (46.7)	21.2 (46.7)
Connections, Intake and Exhaust	DN	16 KF	16 KF	16 KF	16 KF

¹⁾ To DIN 28 400 and following numbers

²⁾ Weight, motor rating and noise levels for the pumps with global version 230 V, 50 Hz AC motor only.

Any data that deviate from the above for pumps with other motors, and other motor-dependent data are given in section "Products", paragraph "Motor Dependent Data for the TRIVAC B, BCS and BCS-PFPE"

³⁾ Global versions only. North and South American versions are TEFC

Ordering Information

TRIVAC D 4 B two-stage

TRIVAC D 8 B two-stage

TRIVAC B without motor	Part No. 113 07	Part No. 113 17
with 1-phase motor 230 V, 50 Hz ¹⁾	Part No. 112 45	Part No. 112 55
with 3-phase motor 230/400 V, 50 Hz / 250/440 V, 60 Hz ¹⁾	Part No. 112 46	Part No. 112 56
230/400 V, 50 Hz, ATEX Category 3 inside and 3 outside inside: II (i) 3G IIC T4 (50 Hz) outside: II (o) 3G IIC T3 (50 Hz)	Part No. 140 140	Part No. 140 150
with dual voltage motor ²⁾ 100-120 V, 50/60 Hz and 200-240 V, 50/60 Hz	Part No. 140 081 ²⁾	Part No. 140 082 ²⁾
Mains cord for dual voltage motor ²⁾ 230 V earthed plug 230 V UK plug 230 V CH plug 230 V NEMA plug (200-240 V) 115 V NEMA plug (100-120 V)	Part No. 200 81 091 Part No. 200 81 097 Part No. 200 81 099 Part No. 200 81 141 Part No. 200 81 090	Part No. 200 81 091 Part No. 200 81 097 Part No. 200 81 099 Part No. 200 81 141 Part No. 200 81 090
Transition connector (250 V AC, 10 A, L+N+PE) only necessary in Switzerland for 1~ pumps	Part No. 800 001 274	Part No. 800 001 274

Accessories

FS 2-4 dust filter	Part No. 186 05	Part No. 186 05
FA 2-4 fine vacuum adsorption trap	Part No. 187 05	Part No. 187 05
Adsorption trap with aluminium oxide	Part No. 854 14	Part No. 854 14
Activated aluminium oxide, 1.3 kg (2 l approx.)	Part No. 854 10	Part No. 854 10
TK 4-8 cold trap	Part No. 188 20	Part No. 188 20
AF 4-8 exhaust filter	Part No. 189 06	Part No. 189 06
AR 4-8 exhaust filter with lubricant return	Part No. 189 20	Part No. 189 20
AK 4-8 condensate trap	Part No. 188 06	Part No. 188 06
OF 4-25 mechanical oil filter	Part No. 101 91	Part No. 101 91
CF 4-25 chemical oil filter	Part No. 101 96	Part No. 101 96
Connector for gas ballast inlet M 16 x 1.5 – DN 16 KF	Part No. 168 40	Part No. 168 40
Oil drain tap M 16 x 1.5	Part No. 190 90	Part No. 190 90

Spare Parts

Inside section	Part No. E 200 10 989	Part No. E 200 10 991
Seal kit	Part No. 197 20	Part No. 197 20

¹⁾ Certification after 94/9/EG (ATEX), Category 3 inside. Inside: II (i) 3G IIC T4 (50 Hz), T3 (60 Hz)

²⁾ A mains cord needs to be ordered additionally

Only available for purchase in North and South America

Ordering Information

**TRIVAC D 4 B
two-stage**

**TRIVAC D 8 B
two-stage**

<p>TRIVAC B with 1-phase motor 115 V, 60/50 Hz, NEMA plug 208-230 V, 60/50 Hz, NEMA plug with 3-phase motor 208-230/460 V, 60 Hz / 200-220/380 V, 50 Hz</p>	<p>Part No. 912 45-1 Part No. 912 45-2</p> <p>Part No. 912 46-2</p>	<p>Part No. 912 55-1 Part No. 912 55-2</p> <p>Part No. 912 56-2</p>
---	--	--

TRIVAC D 16 B and D 25 B

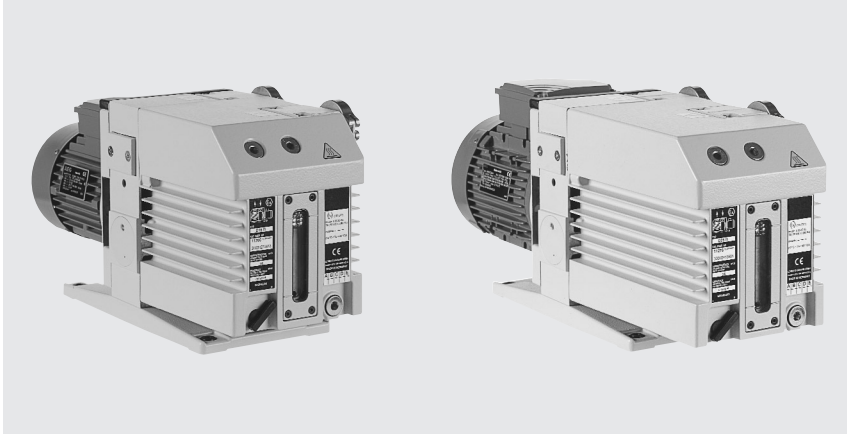

TRIVAC D 16 B (left) and TRIVAC D 25 B (right)

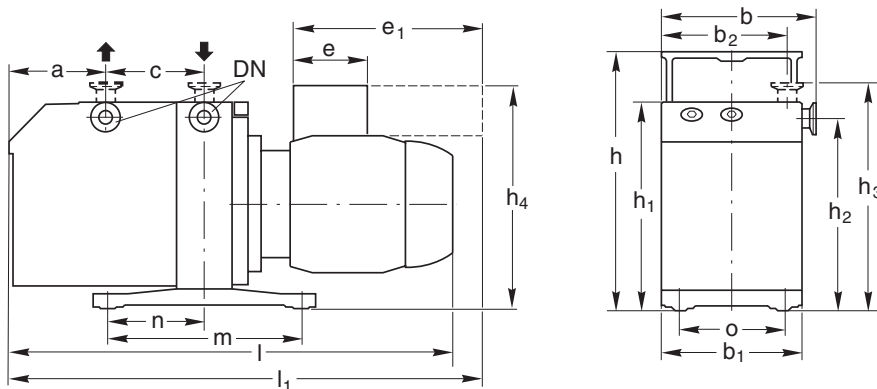

USA pumps max. length
 D 16 B: 560 mm (22.1")
 D 25 B: 660 mm (26")

Type	DN	a	b	b ₁	b ₂	c	e	e ₁	h	h ₁	h ₂	h ₃	h ₄	l	l ₁	m	n	o	
D 16 B (Part No. 113 29)	25 KF	mm	82	190	177	150	135	-	266	298	250	226	263	271	-	566	280	140	132
		in.	3.23	7.48	6.97	5.91	5.32	-	10.47	11.73	9.84	8.90	10.35	10.67	-	22.28	11.02	5.51	5.20
D 16 B (Part No. 112 66, 113 33)	25 KF	mm	82	190	175	150	135	89	-	298	250	226	263	236	490	-	280	140	132
		in.	3.23	7.48	6.89	5.91	5.32	3.50	-	11.73	9.84	8.90	10.35	9.29	19.29	-	11.02	5.51	5.20
D 16 B (Part No. 140 160)	25 KF	mm	82	190	175	150	135	127	-	u. r.	u. r.	u. r.	u. r.	262	515	-	u. r.	u. r.	u. r.
		in.	3.23	7.48	6.89	5.91	5.32	5.0	-	u. r.	u. r.	u. r.	u. r.	10.32	20.28	-	u. r.	u. r.	u. r.
D 16 B (Part No. 112 65, 113 34)	25 KF	mm	82	190	175	150	135	111	-	298	250	226	263	262	507	-	280	140	132
		in.	3.23	7.48	6.89	5.91	5.32	4.37	-	11.73	9.84	8.90	10.35	10.32	19.96	-	11.02	5.51	5.20
D 16 B (Part No. 113 25)	25 KF	mm	82	190	175	150	135	111	-	298	250	226	263	262	512	-	280	140	132
		in.	3.23	7.48	6.89	5.91	5.32	4.37	-	11.73	9.84	8.90	10.35	10.32	20.16	-	11.02	5.51	5.20
D 25 B (Part No. 113 36, 113 39, 113 48)	25 KF	mm	142	190	177	150	135	-	266	298	250	226	263	271	-	626	280	140	132
		in.	5.59	7.48	6.97	5.91	5.32	-	10.47	11.73	9.84	8.90	10.35	10.67	-	24.65	11.02	5.51	5.20
D 25 B (Part No. 112 76)	25 KF	mm	142	190	177	150	135	111	-	298	250	226	263	262	566	-	280	140	132
		in.	5.59	7.48	6.97	5.91	5.32	4.37	-	11.73	9.84	8.90	10.35	10.32	22.28	-	11.02	5.51	5.20
D 25 B (Part No. 112 75)	25 KF	mm	142	190	177	150	135	111	-	298	250	226	263	262	568	-	280	140	132
		in.	5.59	7.48	6.97	5.91	5.32	4.37	-	11.73	9.84	8.90	10.35	10.32	22.36	-	11.02	5.51	5.20
D 25 B (Part No. 113 35)	25 KF	mm	142	190	177	150	135	111	-	298	250	226	263	262	573	-	280	140	132
		in.	5.59	7.48	6.97	5.91	5.32	4.37	-	11.73	9.84	8.90	10.35	10.32	22.56	-	11.02	5.51	5.20
D 25 B (Part No. 140 170)	25 KF	mm	142	190	177	150	135	127	-	u. r.	u. r.	u. r.	u. r.	262	576	-	u. r.	u. r.	u. r.
		in.	5.59	7.48	6.97	5.91	5.32	5.0	-	u. r.	u. r.	u. r.	u. r.	10.32	20.28	-	u. r.	u. r.	u. r.

u. r. = upon request

Dimensional drawing for the TRIVAC D 16 and D 25 B

Technical Data

TRIVAC D 16 B two-stage

TRIVAC D 25 B two-stage

		50 Hz	60 Hz	50 Hz	60 Hz
Nominal pumping speed ¹⁾	m ³ x h ⁻¹ (cfm)	18.9 (11.1)	22.7 (13.4)	29.5 (17.4)	35.4 (20.9)
Pumping speed ¹⁾	m ³ x h ⁻¹ (cfm)	16.5 (9.7)	19.8 (11.7)	25.7 (15.1)	30.8 (18.2)
Ultimate partial pressure without gas ballast ¹⁾	mbar (Torr)	10 ⁻⁴ (0.75 x 10 ⁻⁴)	10 ⁻⁴ (0.75 x 10 ⁻⁴)	10 ⁻⁴ (0.75 x 10 ⁻⁴)	10 ⁻⁴ (0.75 x 10 ⁻⁴)
Ultimate total pressure without gas ballast ¹⁾	mbar (Torr)	< 2 x 10 ⁻³ (1.5 x 10 ⁻³)	< 2 x 10 ⁻³ (1.5 x 10 ⁻³)	< 2 x 10 ⁻³ (1.5 x 10 ⁻³)	< 2 x 10 ⁻³ (1.5 x 10 ⁻³)
Ultimate total pressure with gas ballast ¹⁾	mbar (Torr)	< 5 x 10 ⁻³ (3.8 x 10 ⁻³)	< 5 x 10 ⁻³ (3.8 x 10 ⁻³)	< 5 x 10 ⁻³ (3.8 x 10 ⁻³)	< 5 x 10 ⁻³ (3.8 x 10 ⁻³)
Water vapor tolerance ¹⁾	mbar (Torr)	25 (18.8)	25 (18.8)	25 (18.8)	25 (18.8)
Water vapor capacity	g/h	305	305	476	476
Oil filling, min. / max.	l (qt)	0.5 / 1.0 (0.5 / 1.1)	0.5 / 1.0 (0.5 / 1.1)	0.6 / 1.4 (0.6 / 1.5)	0.6 / 1.4 (0.6 / 1.5)
Noise level ²⁾ to DIN 45 635, without / with gas ballast	dB(A)	52 / 62	52 / 62	52 / 62	52 / 62
Admissible ambient temperature	°C (°F)	12 - 40 (54 - 104)	12 - 40 (54 - 104)	12 - 40 (54 - 104)	12 - 40 (54 - 104)
Motor rating ²⁾	W (HP)	550 - 750 (0.75 - 1.0)	550 - 750 (0.75 - 1.0)	750 (1)	750 (1)
Nominal speed	rpm	1500	1800	1500	1800
Type of protection ³⁾	IP	54	54	54	54
Weight ²⁾	kg (lbs)	26 (57.3)	26 (57.3)	32 (70.6)	32 (70.6)
Connections, Intake and Exhaust	DN	25 KF	25 KF	25 KF	25 KF

¹⁾ To DIN 28 400 and following numbers

²⁾ Weight, motor rating and noise levels for the pumps with global version AC motor, 50 Hz, only.

Any data that deviate from the above for pumps with other motors, and other motor-dependent data are given in section "Products", paragraph "Motor Dependent Data for the TRIVAC B, BCS and BCS-PFPE"

³⁾ Global versions only. North and South American versions are TEFC

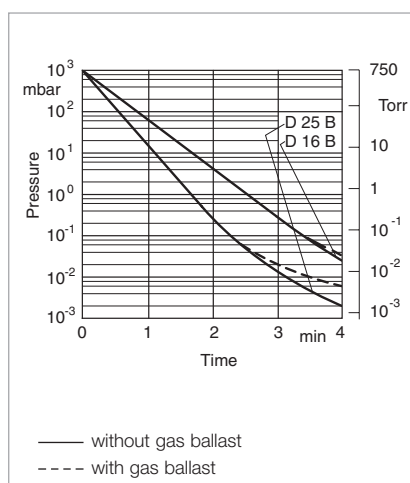

Pump-down characteristics of a 100 l vessel at 50 Hz

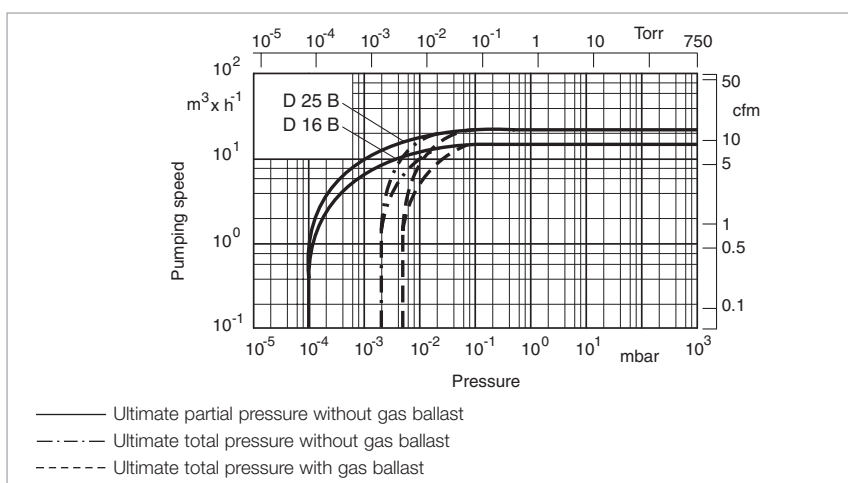

Pumping speed characteristics at 50 Hz (60 Hz curves at the end of the section)

Ordering Information

TRIVAC D 16 B two-stage

TRIVAC D 25 B two-stage

TRIVAC B		
without motor	Part No. 113 28	Part No. 113 38
with 1-phase motor		-
230 V, 50 Hz ¹⁾	Part No. 112 65	
230 V, 50/60 Hz ¹⁾	Part No. 113 25 ²⁾	Part No. 113 35 ²⁾ / 112 75
100 V, 50 Hz / 110 V, 60 Hz	upon request	upon request
115 V, 60 Hz	-	Part No. 113 48
with 3-phase motor		
230/400 V, 50 Hz / 250/440 V, 60 Hz ¹⁾	Part No. 112 66	Part No. 112 76
230/400 V, 50 Hz / 250/440 V, 60 Hz	Part No. 113 33 (RCF - E96N)	-
200/346 V, 50 Hz / 208/360 V, 60 Hz	Part No. 113 34 (RCF - E96N)	-
230/400 V, 50 Hz, ATEX Category 3 inside and 3 outside		
inside: II (j) 3G IIC T4 (50 Hz)	Part No. 140 160	Part No. 140 170
outside: II (o) 3G IIC T3 (50 Hz)		

Accessories

FS 8-16 dust filter	Part No. 186 10	Part No. 186 10
AS 8-16 dust separator	Part No. 186 11	Part No. 186 11
MF 8-16 molecular filter	Part No. 186 12	Part No. 186 12
FA 8-16 fine vacuum adsorption trap	Part No. 187 10	Part No. 187 10
Adsorption trap with aluminium oxide	Part No. 854 15	Part No. 854 15
Activated aluminium oxide, 1.3 kg (2 l approx.)	Part No. 854 10	Part No. 854 10
AF 16-25 exhaust filter	Part No. 189 11	Part No. 189 11
AR 16-25 exhaust filter with lubricant return	Part No. 189 21	Part No. 189 21
AK 16-25 condensate trap	Part No. 188 11	Part No. 188 11
OF 4-25 mechanical oil filter	Part No. 101 91	Part No. 101 91
CF 4-25 chemical oil filter	Part No. 101 96	Part No. 101 96
Connector for gas ballast inlet M 16 x 1.5 – DN 16 KF	Part No. 168 40	Part No. 168 40
Oil drain tap	Part No. 190 90	Part No. 190 90

Spare Parts

Inside section		
Seal kit		

¹⁾ Certification after 94/9/EG (ATEX), Category 3 inside. Inside: II (j) 3G IIC T4 (50 Hz), T3 (60 Hz)

²⁾ with cable Euro-Schuko. Other cables upon request

Only available for purchase in North and South America

Ordering Information

**TRIVAC D 16 B
two-stage**

**TRIVAC D 25 B
two-stage**

<p>TRIVAC B with 1-phase motor 115 V, 60/50 Hz, NEMA plug 208-230 V, 60/50 Hz, NEMA plug with 3-phase motor 208-230/460 V, 60 Hz / 200-220/380 V, 50 Hz</p>	<p>Part No. 912 65-1 Part No. 912 65-2</p> <p>Part No. 912 66-2</p>	<p>Part No. 912 75 V 001 Part No. 912 75-2</p> <p>Part No. 912 76-2</p>
---	--	--

TRIVAC D 40 B and D 65 B

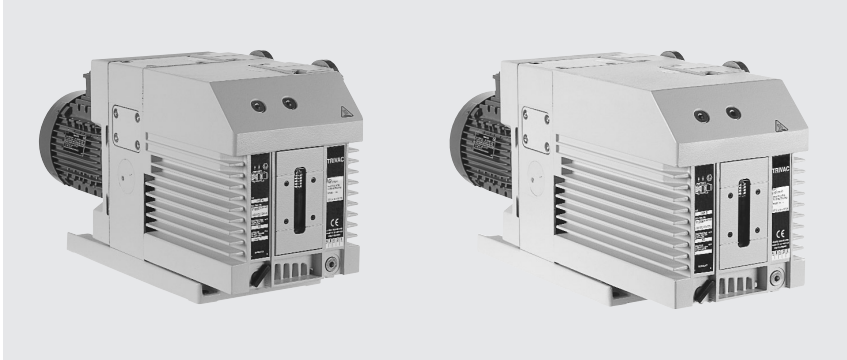

TRIVAC D 40 B (left) und TRIVAC D 65 B (right)

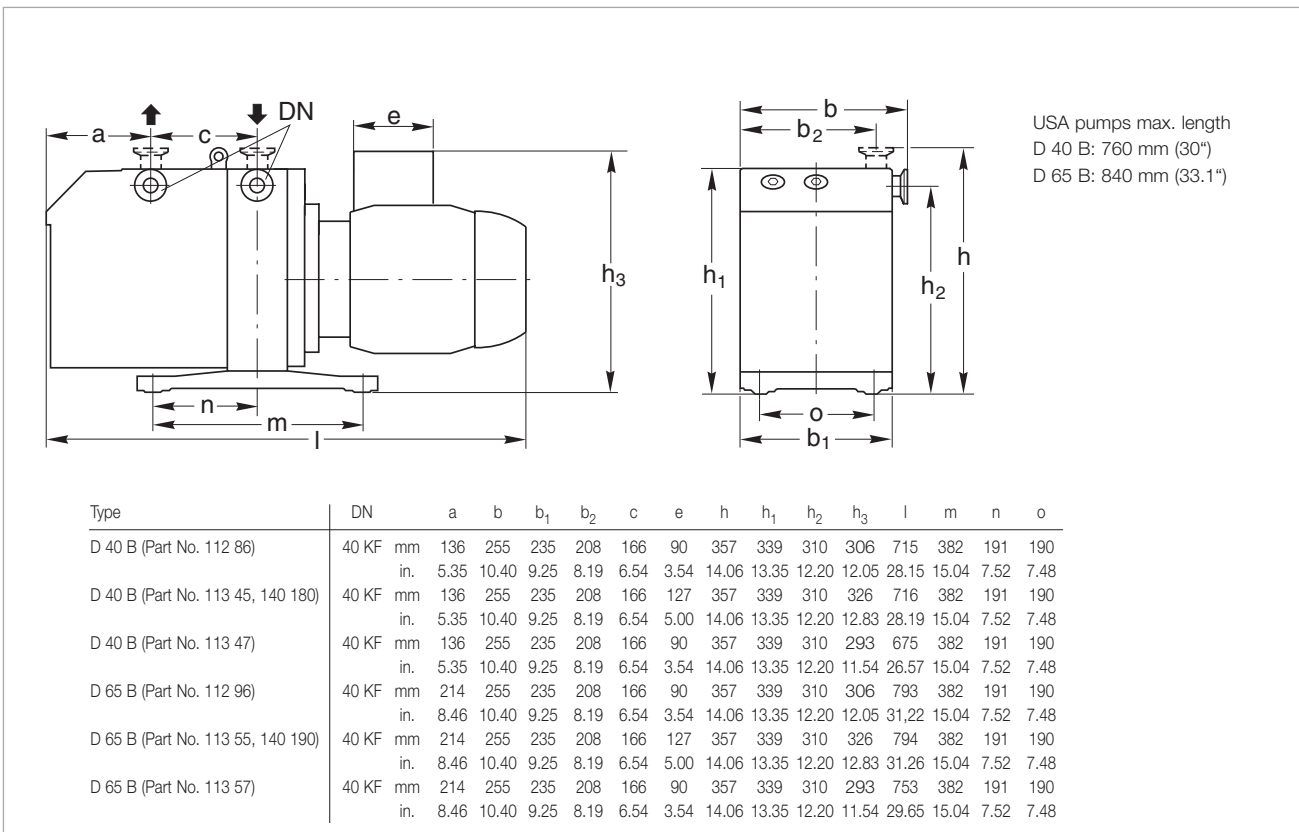

Dimensional drawing for the TRIVAC D 40 and D 65 B

Technical Data

TRIVAC D 40 B two-stage

TRIVAC D 65 B two-stage

		50 Hz	60 Hz	50 Hz	60 Hz
Nominal pumping speed ¹⁾	m ³ x h ⁻¹ (cfm)	46 (27)	55 (32.5)	75 (44)	90 (53)
Pumping speed ¹⁾	m ³ x h ⁻¹ (cfm)	40 (24)	48 (28)	65 (38)	78 (46)
Ultimate partial pressure without gas ballast ¹⁾	mbar (Torr)	10 ⁻⁴ (0.75 x 10 ⁻⁴)	10 ⁻⁴ (0.75 x 10 ⁻⁴)	10 ⁻⁴ (0.75 x 10 ⁻⁴)	10 ⁻⁴ (0.75 x 10 ⁻⁴)
Ultimate total pressure without gas ballast ¹⁾	mbar (Torr)	< 2 x 10 ⁻³ (< 1.5 x 10 ⁻³)	< 2 x 10 ⁻³ (< 1.5 x 10 ⁻³)	< 2 x 10 ⁻³ (< 1.5 x 10 ⁻³)	< 2 x 10 ⁻³ (< 1.5 x 10 ⁻³)
Ultimate total pressure with gas ballast ¹⁾	mbar (Torr)	< 5 x 10 ⁻³ (< 3.8 x 10 ⁻³)	< 5 x 10 ⁻³ (< 3.8 x 10 ⁻³)	< 5 x 10 ⁻³ (< 3.8 x 10 ⁻³)	< 5 x 10 ⁻³ (< 3.8 x 10 ⁻³)
Water vapor tolerance ¹⁾	mbar (Torr)	40 (30)	40 (30)	40 (30)	40 (30)
Water vapor capacity	g/h	1184	1184	1925	1925
Oil filling, min. / max.	l (qt)	1.7 / 2.6 (1.8 / 2.7)	1.7 / 2.6 (1.8 / 2.7)	2.0 / 3.3 (2.1 / 3.5)	2.0 / 3.3 (2.1 / 3.5)
Noise level ²⁾ to DIN 45 635, without / with gas ballast	dB(A)	57 / 59	57 / 59	57 / 59	57 / 59
Admissible ambient temperature	°C (°F)	12 - 40 (54 - 104)	12 - 40 (54 - 104)	12 - 40 (54 - 104)	12 - 40 (54 - 104)
Motor rating ²⁾	W (HP)	2200 (3.0)	2200 (3.0)	2200 (3.0)	2200 (3.0)
Nominal speed	rpm	1420	1710	1420	1710
Type of protection ³⁾	IP	54	54	54	54
Weight ²⁾	kg (lbs)	68 (150)	68 (150)	80 (177)	80 (177)
Connections, Intake and Exhaust	DN	40 KF	40 KF	40 KF	40 KF

¹⁾ To DIN 28 400 and following numbers

²⁾ Weight, motor rating and noise levels for the pumps with global version 3-phase motor, 50 Hz, only.

Any data that deviate from the above for pumps with other motors, and other motor-dependent data are given in section "Products", paragraph "Motor Dependent Data for the TRIVAC B, BCS and BCS-PFPE"

³⁾ Global versions only. North and South American versions are TEFC

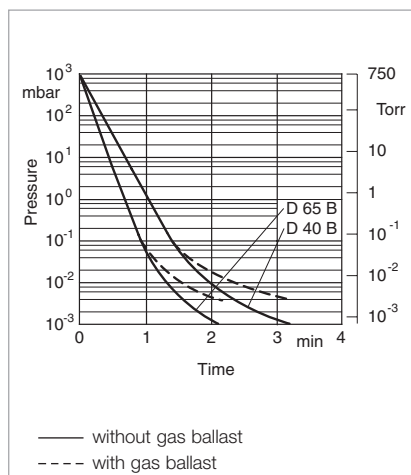

Pump-down characteristics of a 100 l vessel at 50 Hz

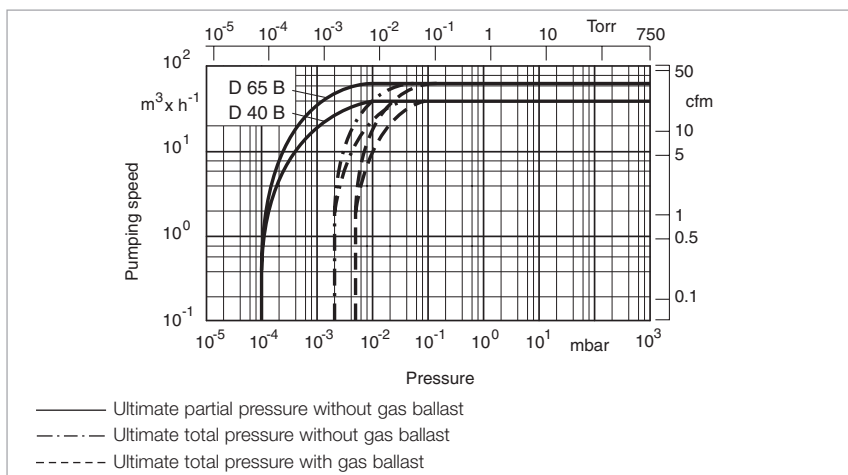

Pumping speed characteristics at 50 Hz (60 Hz curves at the end of the section)

Ordering Information**TRIVAC D 40 B****TRIVAC D 65 B****two-stage****two-stage**

TRIVAC B without motor	Part No. 113 46	Part No. 113 56
with 3-phase motor 230/400 V, 50 Hz / 250/440 V, 60 Hz ¹⁾	Part No. 112 86	Part No. 112 96
200/346 V, 50 Hz / 208/360 V, 60 Hz	Part No. 113 47	Part No. 113 57
230/400 V, 50 Hz, ATEX Category 3 inside and 3 outside inside: II (I) 3G IIC T4 (50 Hz) outside: II (o) 3G IIC T3 (50 Hz)	Part No. 140 180	Part No. 140 190
Accessories		
Roots pump adaptor	Part No. 168 30	Part No. 168 30
FS 30-60 dust filter	Part No. 186 15	Part No. 186 15
AS 30-60 dust separator	Part No. 186 16	Part No. 186 16
MF 30-60 molecular filter	Part No. 186 17	Part No. 186 17
FA 30-60 fine vacuum adsorption trap	Part No. 187 15	Part No. 187 15
Adsorption trap with aluminium oxide	Part No. 854 16	Part No. 854 16
Activated aluminium oxide, 1.3 kg (2 l approx.)	Part No. 854 10	Part No. 854 10
AF 40-65 exhaust filter	Part No. 189 16	Part No. 189 16
AR 40-65 exhaust filter with lubricant return	Part No. 189 22	Part No. 189 22
AK 40-65 condensate trap	Part No. 188 16	Part No. 188 16
OF 40-65 mechanical oil filter	Part No. 101 92	Part No. 101 92
CF 40-65 chemical oil filter	Part No. 101 97	Part No. 101 97
Connector for gas ballast inlet M 16 x 1.5 – DN 16 KF	Part No. 168 40	Part No. 168 40
Oil drain tap	Part No. 190 90	Part No. 190 90
Spare Parts		
Inside section	Part No. E 200 10 933	Part No. E 200 10 944
Seal kit	Part No. 197 22	Part No. 197 22

¹⁾ Certification after 94/9/EG (ATEX), Category 3 inside. Inside: II (I) 3G IIC T4 (50 Hz), T3 (60 Hz)

Only available for purchase in North and South America

Ordering Information

TRIVAC D 40 B two-stage

TRIVAC D 65 B two-stage

TRIVAC B with 3-phase motor 208-230/460 V, 60 Hz / 200-220/380 V, 50 Hz	Part No. 912 86-2	Part No. 912 96-2
--	--------------------------	--------------------------

TRIVAC D 16 B-DOT

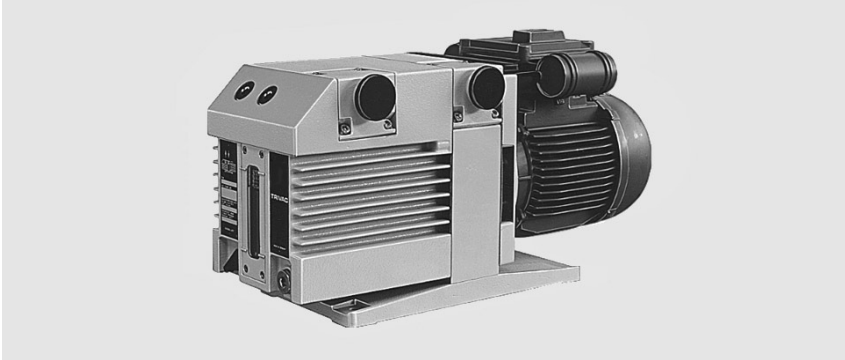

TRIVAC D 16 B-DOT

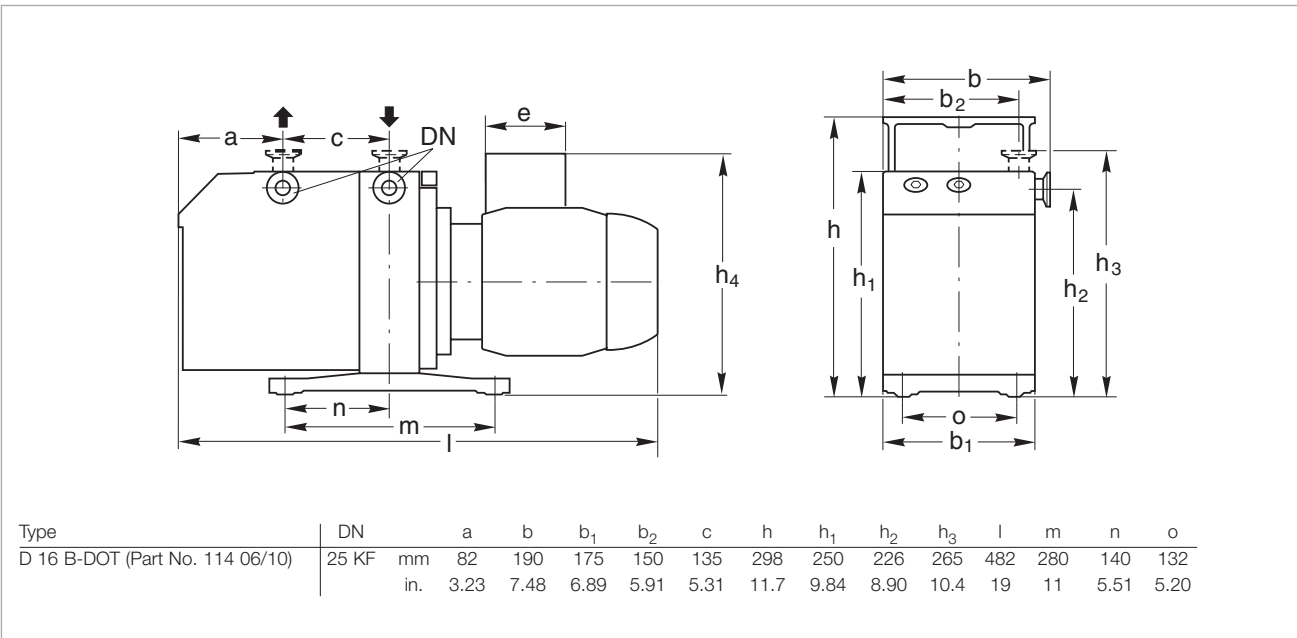

Dimensional drawing for the TRIVAC D 16 B-DOT

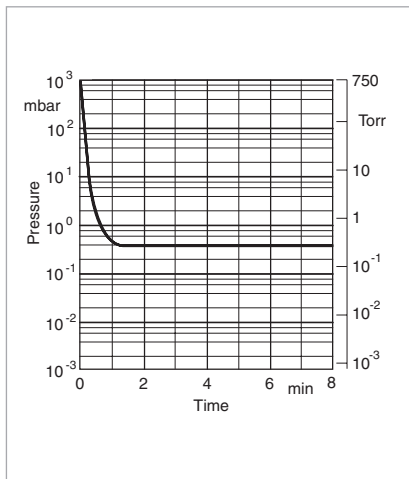

Pump-down characteristics of a 10 l vessel at 50 Hz

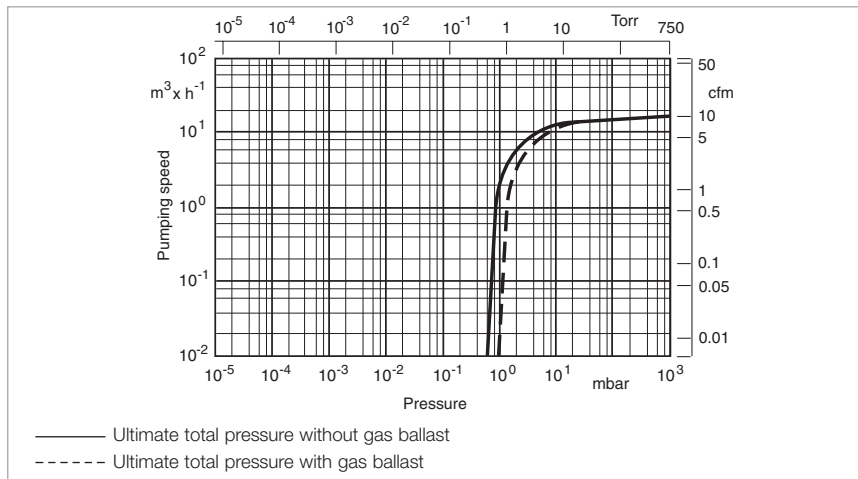

Pumping speed characteristics at 50 Hz (60 Hz curves at the end of the section)

Technical Data

TRIVAC D 16 B-DOT

		50 Hz	60 Hz
Nominal pumping speed ¹⁾	m ³ x h ⁻¹ (cfm)	18.9 (11.1)	22.7 (13.4)
Pumping speed ¹⁾	m ³ x h ⁻¹ (cfm)	16.5 (9.7)	19.8 (11.7)
Ultimate total pressure without gas ballast ¹⁾	mbar (Torr)	< 6 x 10 ⁻¹ (< 4.5 x 10 ⁻¹)	< 6 x 10 ⁻¹ (< 4.5 x 10 ⁻¹)
Ultimate total pressure with gas ballast ¹⁾	mbar (Torr)	< 9 x 10 ⁻¹ (< 6.75 x 10 ⁻¹)	< 9 x 10 ⁻¹ (< 6.75 x 10 ⁻¹)
Water vapor tolerance ¹⁾	mbar (Torr)	25 (18.75)	25 (18.75)
Water vapor capacity	g/h	259	259
Brake fluid filling, min. / max.	l (qt)	0.45 / 1.0 (0.5 / 1.1)	0.45 / 1.0 (0.5 / 1.1)
Noise level to DIN 45 635, without / with gas ballast	dB(A)	52 / 52	52 / 52
Admissible ambient temperature	°C (°F)	12 - 40 (54 - 104)	12 - 40 (54 - 104)
Motor rating	W (HP)	550 (0.75)	550 (0.75)
Nominal speed	rpm	1500	1800
Type of protection ²⁾	IP	54	54
Weight	kg (lbs)	26 (57.3)	26 (57.3)
Connections, Intake and Exhaust	DN	25 KF	25 KF

Ordering Information

TRIVAC D 16 B-DOT

	Global Version	North and South America Version
TRIVAC B-DOT with 3-phase motor 230/400 V, 50 Hz; 250/440 V, 60 Hz 230/400 V, 50 Hz; 250/440 V, 60 Hz with 1-phase motor 115 V, 60 Hz with 3-phase motor 208-230/460 V, 60 Hz 208-220/380 V, 50 Hz	Part No. 114 06 Part No. 114 10 (with float switch) - -	- Part No. 914 62 Part No. 914 63
AF 16-25 DOT exhaust filter	Part No. 124 16	Part No. 124 16
AK 16 DOT condensate trap	Part No. 110 78	Part No. 110 78
Seal kit	Part No. 200 39 059	Part No. 200 39 059

¹⁾ To DIN 28 400 and following numbers

²⁾ Global versions only. North and South American versions are TEFC

As to the D 8 B-DOT, D 25 B-DOT and D 40 B-DOT please ask us for a quotation.